

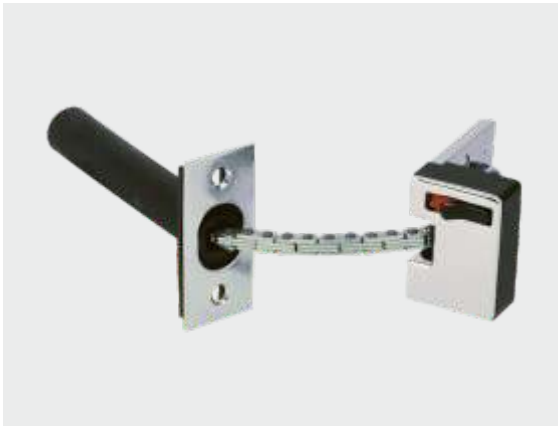

German quality you can trust



Door Accessories
Plan • Design • Realise



Master Catalogue 2016



ProDecor 2016

Technik für Tür



PVC Door Seals

Conventional/Intumescent Seals

| Product Image | Product Name | Description (Height x Width) | Unit | Article no. | PU |
|---------------|--------------|---|------|-------------|----|
| | HSQ1-40E | D-shape Door Seal 8.5*4.2 mm, 300 metre/box Dark Brown | Box | 9 228 359 | 01 |
| | HSQ1-40E | D-shape Door Seal 8.5*4.2 mm, 300 metre/box White | Box | 9 228 635 | 01 |
| | HSQ1-40E | D-shape Door Seal 8.5*4.2 mm, 300 metre/box Cherry | Box | 9 228 656 | 01 |
| | HSQ1-40E | D-shape Door Seal 8.5*4.2 mm, 300 metre/box Light Yellow | Box | 9 228 680 | 01 |
| | HSQ1-84E | D-shape Door Seal 10*5 mm, 250 metre/box Dark Brown | Box | 9 228 360 | 01 |
| | HSQ1-84E | D-shape Door Seal 10*5 mm, 250 metre/box White | Box | 9 228 636 | 01 |
| | HSQ1-84E | D-shape Door Seal 10*5 mm, 250 metre/box Cherry | Box | 9 228 657 | 01 |
| | HSQ1-84E | D-shape Door Seal 10*5 mm, 250 metre/box Light Yellow | Box | 9 228 681 | 01 |
| | HSQ1-47E | Wedge Shape Door Seal 10*5 mm, 250 metre/box Dark Brown | Box | 9 228 361 | 01 |
| | HSQ1-47E | Wedge Shape Door Seal 10*5 mm, 250 metre/box White | Box | 9 228 637 | 01 |
| | HSQ1-47E | Wedge Shape Door Seal 10*5 mm, 250 metre/box Cherry | Box | 9 228 658 | 01 |
| | HSQ1-47E | Wedge Shape Door Seal 10*5 mm, 250 metre/box Light Yellow | Box | 9 228 682 | 01 |
| | HSQ1-49E-120 | Wedge Shape Door Seal 12*6 mm, 150 metre/box Dark Brown | Box | 9 228 362 | 01 |
| | HSQ1-49E-120 | Wedge Shape Door Seal 12*6 mm, 150 metre/box White | Box | 9 228 638 | 01 |
| | HSQ1-49E-120 | Wedge Shape Door Seal 12*6 mm, 150 metre/box Cherry | Box | 9 228 659 | 01 |
| | HSQ1-49E-120 | Wedge Shape Door Seal 12*6 mm, 150 metre/box Light Yellow | Box | 9 228 683 | 01 |
| | HSQ1-RC01E | Wedge Shape Door Seal 10*4.5 mm, 150 metre/box Dark Brown | Box | 9 228 363 | 01 |
| | HSQ1-RC01E | Wedge Shape Door Seal 10*4.5 mm, 150 metre/box White | Box | 9 228 463 | 01 |
| | HSQ1-RC01E | Wedge Shape Door Seal 10*4.5 mm, 150 metre/box Cherry | Box | 9 228 660 | 01 |
| | HSQ1-RC01E | Wedge Shape Door Seal 10*4.5 mm, 150 metre/box Light Yellow | Box | 9 228 684 | 01 |
| | HSQ1-36 | D-shape Door Seal 7.8*3.9 mm, 300 metre/box Dark Brown | Box | 9 228 364 | 01 |
| | HSQ1-36 | D-shape Door Seal 7.8*3.9 mm, 300 metre/box White | Box | 9 228 639 | 01 |
| | HSQ1-36 | D-shape Door Seal 7.8*3.9 mm, 300 metre/box Cherry | Box | 9 228 661 | 01 |
| | HSQ1-36 | D-shape Door Seal 7.8*3.9 mm, 300 metre/box Light yellow | Box | 9 228 685 | 01 |
| | HSQ1-06 | D-shape Door Seal 8.5*5 mm, 300 metre/box Dark Brown | Box | 9 228 365 | 01 |
| | HSQ1-06 | D-shape Door Seal 8.5*5 mm, 300 metre/box White | Box | 9 228 640 | 01 |
| | HSQ1-06 | D-shape Door Seal 8.5*5 mm, 300 metre/box Cherry | Box | 9 228 662 | 01 |
| | HSQ1-06 | D-shape Door Seal 8.5*5 mm, 300 metre/box Light yellow | Box | 9 228 686 | 01 |
| | HSQ1-24 | D-shape Door Seal 8.5*7mm, 200 metre/box Dark Brown | Box | 9 228 366 | 01 |
| | HSQ1-24 | D-shape Door Seal 8.5*7 mm, 200 metre/box White | Box | 9 228 641 | 01 |
| | HSQ1-24 | D-shape Door Seal 8.5*7 mm, 200 metre/box Cherry | Box | 9 228 663 | 01 |
| | HSQ1-24 | D-shape Door Seal 8.5*7 mm, 200 metre/box Light yellow | Box | 9 228 687 | 01 |
| | HSQ1-10 | D-shape Door Seal 11.8*5.5 mm, 200 metre/box Dark Brown | Box | 9 228 367 | 01 |
| | HSQ1-10 | D-shape Door Seal 11.8*5.5 mm, 200 metre/box White | Box | 9 228 642 | 01 |
| | HSQ1-10 | D-shape Door Seal 11.8*5.5 mm, 200 metre/box Cherry | Box | 9 228 664 | 01 |
| | HSQ1-10 | D-shape Door Seal 11.8*5.5 mm, 200 metre/box Light yellow | Box | 9 228 688 | 01 |
| | HSQ1-38 | D-shape Door Seal 9*4.5 mm, 300 metre/box Dark Brown | Box | 9 228 368 | 01 |
| | HSQ1-38 | D-shape Door Seal 9*4.5 mm, 300 metre/box White | Box | 9 228 643 | 01 |
| | HSQ1-38 | D-shape Door Seal 9*4.5 mm, 300 metre/box Cherry | Box | 9 228 665 | 01 |
| | HSQ1-38 | D-shape Door Seal 9*4.5 mm, 300 metre/box Light Yellow | Box | 9 228 689 | 01 |
| | HSQ1-38-100 | D-shape Door Seal 10*5 mm, 250 metre/box Dark Brown | Box | 9 228 369 | 01 |
| | HSQ1-38-100 | D-shape Door Seal 10*5 mm, 250 metre/box White | Box | 9 228 644 | 01 |
| | HSQ1-38-100 | D-shape Door Seal 10*5 mm, 250 metre/box Cherry | Box | 9 228 666 | 01 |
| | HSQ1-38-100 | D-shape Door Seal 10*5 mm, 250 metre/box Light Yellow | Box | 9 228 690 | 01 |

■ Dark Brown
 □ White
 ■ Cherry
 ■ Light Yellow

PVC Door Seals

Conventional/Intumescent Seals

| Product Image | Product Name | Description (Height x Width) | Unit | Article no. | PU |
|---|--------------|---|------|-------------|----|
|  | HSQ1-37 | D-shape Door Seal 8.5*4.2 mm, 300 metre/box Dark Brown | Box | 9 228 370 | 01 |
| | HSQ1-37 | D-shape Door Seal 8.5*4.2 mm, 300 metre/box White | Box | 9 228 645 | 01 |
| | HSQ1-37 | D-shape Door Seal 8.5*4.2 mm, 300 metre/box Cherry | Box | 9 228 667 | 01 |
| | HSQ1-37 | D-shape Door Seal 8.5*4.2 mm, 300 metre/box Light Yellow | Box | 9 228 691 | 01 |
|  | HSQ1-25-100 | Wedge Shape Door Seal 10*5 mm, 250 metre/box Dark Brown | Box | 9 228 371 | 01 |
| | HSQ1-25-100 | Wedge Shape Door Seal 10*5 mm, 250 metre/box White | Box | 9 228 646 | 01 |
| | HSQ1-25-100 | Wedge Shape Door Seal 10*5 mm, 250 metre/box Cherry | Box | 9 228 668 | 01 |
| | HSQ1-25-100 | Wedge Shape Door Seal 10*5 mm, 250 metre/box Light Yellow | Box | 9 228 692 | 01 |
|  | HSQ1-25-120 | Wedge Shape Door Seal 12*6mm, 200metre/box Dark Brown | Box | 9 228 372 | 01 |
| | HSQ1-25-120 | Wedge Shape Door Seal 12*6mm, 200metre/box White | Box | 9 228 647 | 01 |
| | HSQ1-25-120 | Wedge Shape Door Seal 12*6mm, 200metre/box Cherry | Box | 9 228 669 | 01 |
| | HSQ1-25-120 | Wedge Shape Door Seal 12*6mm, 200metre/box Light Yellow | Box | 9 228 693 | 01 |
|  | HSQ1-22 | Wedge Shape Door Seal 10*6.5 mm, 200 metre/box Dark Brown | Box | 9 228 373 | 01 |
| | HSQ1-22 | Wedge Shape Door Seal 10*6.5 mm, 200 metre/box White | Box | 9 228 648 | 01 |
| | HSQ1-22 | Wedge Shape Door Seal 10*6.5 mm, 200 metre/box Cherry | Box | 9 228 670 | 01 |
| | HSQ1-22 | Wedge Shape Door Seal 10*6.5 mm, 200 metre/box Light Yellow | Box | 9 228 694 | 01 |
|  | HSQ1-17 | Wedge Shape Door Seal 12*8 mm, 150 metre/box Dark Brown | Box | 9 228 374 | 01 |
| | HSQ1-17 | Wedge Shape Door Seal 12*8 mm, 150 metre/box White | Box | 9 228 649 | 01 |
| | HSQ1-17 | Wedge Shape Door Seal 12*8 mm, 150 metre/box Cherry | Box | 9 228 671 | 01 |
| | HSQ1-17 | Wedge Shape Door Seal 12*8 mm, 150 metre/box Light Yellow | Box | 9 228 695 | 01 |
|  | HSQ1-73 | Wedge Shape Door Seal 15*7 mm, 150 metre/box Dark Brown | Box | 9 228 375 | 01 |
| | HSQ1-73 | Wedge Shape Door Seal 15*7 mm, 150 metre/box White | Box | 9 228 650 | 01 |
| | HSQ1-73 | Wedge Shape Door Seal 15*7 mm, 150 metre/box Cherry | Box | 9 228 672 | 01 |
| | HSQ1-73 | Wedge Shape Door Seal 15*7 mm, 150 metre/box Light Yellow | Box | 9 228 696 | 01 |

Self Adhesive Seals

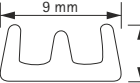
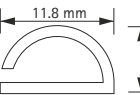
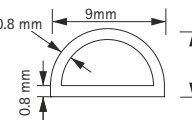
| | | | | | |
|---|---------|--|-----|-----------|----|
|  | HSQ1-11 | E- shape Adhesive Seal 9*3.5 mm, 50 metre/box Dark Brown | Box | 9 228 376 | 01 |
| | HSQ1-11 | E- shape Adhesive Seal 9*3.5 mm, 50 metre/box White | Box | 9 228 462 | 01 |
| | HSQ1-11 | E- shape Adhesive Seal 9*3.5 mm, 50 metre/box Cherry | Box | 9 228 673 | 01 |
| | HSQ1-11 | E- shape Adhesive Seal 9*3.5 mm, 50 metre/box Light Yellow | Box | 9 228 697 | 01 |
|  | HSQ1-12 | D-Shape Adhesive Seal 11.8*5.5 mm, 50 metre/box Dark Brown | Box | 9 228 377 | 01 |
| | HSQ1-12 | D-Shape Adhesive Seal 11.8*5.5 mm, 50 metre/box White | Box | 9 228 651 | 01 |
| | HSQ1-12 | D-Shape Adhesive Seal 11.8*5.5 mm, 50 metre/box Cherry | Box | 9 228 674 | 01 |
| | HSQ1-12 | D-Shape Adhesive Seal 11.8*5.5 mm, 50 metre/box Light Yellow | Box | 9 228 698 | 01 |
|  | HSQ1-26 | D-Shape Adhesive Seal 9*4.5 mm, 50 metre/box Dark Brown | Box | 9 228 378 | 01 |
| | HSQ1-26 | D-Shape Adhesive Seal 9*4.5 mm, 50 metre/box White | Box | 9 228 461 | 01 |
| | HSQ1-26 | D-Shape Adhesive Seal 9*4.5 mm, 50 metre/box Cherry | Box | 9 228 675 | 01 |
| | HSQ1-26 | D-Shape Adhesive Seal 9*4.5 mm, 50 metre/box Light Yellow | Box | 9 228 699 | 01 |

Ornamental Seals

| | | | | | |
|---|---------|--|-----|-----------|----|
|  | HSQ1-28 | Door Ornamental Seal 7.5*4.7 mm, 400pcs/box, 2.44 m/pcs Dark Brown | Box | 9 228 379 | 01 |
| | HSQ1-28 | Door Ornamental Seal 7.5*4.7 mm, 400pcs/box, 2.44 m/pcs White | Box | 9 228 452 | 01 |
| | HSQ1-28 | Door Ornamental Seal 7.5*4.7 mm, 400pcs/box, 2.44 m/pcs Cherry | Box | 9 228 676 | 01 |
| | HSQ1-28 | Door Ornamental Seal 7.5*4.7 mm, 400pcs/box, 2.44 m/pcs Light yellow | Box | 9 228 700 | 01 |
|  | HSQ1-45 | Door Ornamental Seal 9*3mm, 400pcs/box, 2.44m/pcs Dark Brown | Box | 9 228 380 | 01 |
| | HSQ1-45 | Door Ornamental Seal 9*3mm, 400pcs/box, 2.44m/pcs White | Box | 9 228 653 | 01 |
| | HSQ1-45 | Door Ornamental Seal 9*3mm, 400pcs/box, 2.44m/pcs Cherry | Box | 9 228 677 | 01 |
| | HSQ1-45 | Door Ornamental Seal 9*3mm, 400pcs/box, 2.44m/pcs Light Yellow | Box | 9 228 701 | 01 |

■ Dark Brown
 □ White
 ■ Cherry
 ■ Light Yellow

PVC Door Seals

Ornamental Seals

| Product Image | Product Name | Description (Height x Width) | Unit | Article no. | PU |
|---------------|--------------|---|------|-------------|----|
| | HSQ1-54 | Door Ornamental Seal 9.2*1.05 mm, 400 pcs/box, 2.44m/pcs Dark Brown | Box | 9 228 381 | 01 |
| | HSQ1-54 | Door Ornamental Seal 9.2*1.05 mm, 400 pcs/box, 2.44m/pcs White | Box | 9 228 654 | 01 |
| | HSQ1-54 | Door Ornamental Seal 9.2*1.05 mm, 400 pcs/box, 2.44m/pcs Cherry | Box | 9 228 678 | 01 |
| | HSQ1-54 | Door Ornamental Seal 9.2*1.05 mm, 400 pcs/box, 2.44m/pcs Light Yellow | Box | 9 228 702 | 01 |
| | HSQ1-56 | Door Ornamental Seal 5.1*1.1 mm, 600 pcs/box, 2.44m/pcs Dark Brown | Box | 9 228 382 | 01 |
| | HSQ1-56 | Door Ornamental Seal 5.1*1.1 mm, 600 pcs/box, 2.44m/pcs White | Box | 9 228 655 | 01 |
| | HSQ1-56 | Door Ornamental Seal 5.1*1.1 mm, 600 pcs/box, 2.44m/pcs Cherry | Box | 9 228 679 | 01 |
| | HSQ1-56 | Door Ornamental Seal 5.1*1.1 mm, 600 pcs/box, 2.44m/pcs Light Yellow | Box | 9 228 703 | 01 |

Automatic drop bottom seal

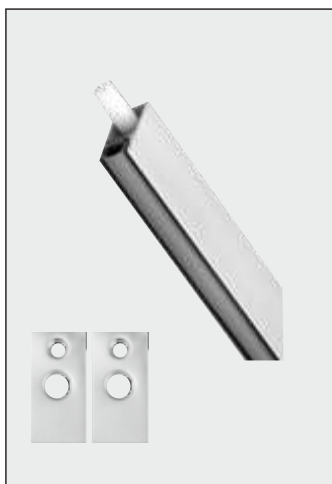

HDS 1 Automatic drop seal for wooden doors

- ▶ Operation stroke: 5 - 15 mm
- ▶ DIN left/right usable
- ▶ Finishes: Aluminum colour

| S.no | Product name | Size | Min Cut Size | Unit | Article No. | PU |
|------|---------------------|--------------|--------------|------|-------------|----|
| 1 | HDS 1: 25 - 33 cm | 30 x 14.5 mm | 25 cm | Pc | 9 228 383 | 01 |
| 2 | HDS 1: 33 - 66 cm | 30 x 14.5 mm | 33 cm | Pc | 9 228 384 | 01 |
| 3 | HDS 1: 66 - 85 cm | 30 x 14.5 mm | 66 cm | Pc | 9 228 385 | 01 |
| 4 | HDS 1: 66 - 100 cm | 30 x 14.5 mm | 66 cm | Pc | 9 228 386 | 01 |
| 5 | HDS 1: 100 - 120 cm | 30 x 14.5 mm | 100 cm | Pc | 9 228 387 | 01 |
| 6 | HDS 1: 120 - 150 cm | 30 x 14.5 mm | 120 cm | Pc | 9 228 388 | 01 |
| 7 | HDS 1: 150 - 185 cm | 30 x 14.5 mm | 150 cm | Pc | 9 228 389 | 01 |

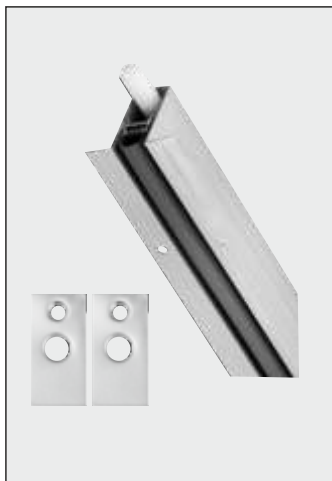

HDS 11 Automatic drop seal for profile frame doors

- ▶ Operation stroke: 5 - 15 mm
- ▶ DIN left/right usable
- ▶ Finishes: Aluminum colour

| S.no | Product name | Size | Min Size | Unit | Article No. | PU |
|------|----------------------|---------------------|----------|------|-------------|----|
| 1 | HDS 11: 25 - 33 cm | 30 x 14.5 x 34.5 mm | 25 cm | Pc | 9 228 390 | 01 |
| 2 | HDS 11: 33 - 66 cm | 30 x 14.5 x 34.5 mm | 33 cm | Pc | 9 228 391 | 01 |
| 3 | HDS 11: 66 - 85 cm | 30 x 14.5 x 34.5 mm | 66 cm | Pc | 9 228 392 | 01 |
| 4 | HDS 11: 66 - 100 cm | 30 x 14.5 x 34.5 mm | 66 cm | Pc | 9 228 393 | 01 |
| 5 | HDS 11: 100 - 120 cm | 30 x 14.5 x 34.5 mm | 100 cm | Pc | 9 228 394 | 01 |
| 6 | HDS 11: 120 - 150 cm | 30 x 14.5 x 34.5 mm | 120 cm | Pc | 9 228 395 | 01 |
| 7 | HDS 11: 150 - 185 cm | 30 x 14.5 x 34.5 mm | 150 cm | Pc | 9 228 396 | 01 |

■ Dark Brown
 □ White
 ■ Cherry
 ■ Light Yellow

Door Accessories



HFB 1: Flush bolt for wooden door

- ▶ Flush bolt for wooden door
- ▶ Single piece with striking plate and screws parts, dust-proof not included
- ▶ Screws included
- ▶ Finishes: SS Satin

| Description | Unit | Article No. | PU |
|--|------|-------------|----|
| HFB 1: Flush bolt for wooden door 200 mm | Pc | 9 228 397 | 01 |
| HFB 1: Flush bolt for wooden door 300 mm | Pc | 9 228 424 | 01 |



HFB 2: Flush bolt for metal door

- ▶ Cover plate spec: 170 mm x 25 mm, square
- ▶ Standard bolt length: 300 mm
- ▶ Single piece with striking plate and screws parts, dust-proof not included
- ▶ Screws included
- ▶ Finishes: SS Satin

| Description | Unit | Article No. | PU |
|----------------------------------|------|-------------|----|
| HFB 2: Flush bolt for metal door | Set | 9 228 398 | 01 |



HFB 3: Center flush bolt for steel door

- ▶ Suitable for steel/aluminum passive leaf
- ▶ Recommended distance from floor: 1.500 mm
- ▶ Cover spec: Square 22 mm x 285 mm x 2.5 mm
- ▶ Body spec: 42 mm x 125 mm x 12 mm
- ▶ Upper & lower rod screw thread: M8
- ▶ Upper & lower rod clutch operating stroke: 20 mm
- ▶ Finishes: SS Satin

| Description | Unit | Article No. | PU |
|---|------|-------------|----|
| HFB 3: Center flush bolt for steel door | Pc | 9 228 399 | 01 |



HFB 4: Automatic flush bolt

- ▶ Size: 158 mm x 41 mm
- ▶ DIN left/right usable
- ▶ Passive leaf would be automatically unlocked when the active leaf is open.
- ▶ Fixing material included
- ▶ Finishes: Stainless steel satin

| Description | Unit | Article No. | PU |
|-----------------------------|------|-------------|----|
| HFB 4: Automatic flush bolt | Pc | 9 228 400 | 01 |

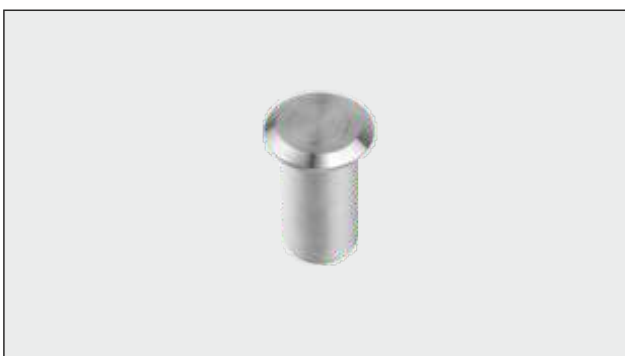

HFBA 1: Dust socket for flush bolt

- ▶ Suitable for Hettich flush bolt series
- ▶ Size: 39 mm x 19 mm
- ▶ Cover plate diameter: 13 mm
- ▶ Depth: 39 mm
- ▶ Strike diameter: 19 mm
- ▶ Finishes: Nickel plating

| Description | Unit | Article No. | PU |
|---------------------------|------|-------------|----|
| HFBA 1: Dust proof strike | Pc | 9 228 401 | 01 |

Door Accessories



HWS 75: Magnetic Wall Stop (Floor Mounted)

- ▶ Base diameter: 50 mm, Height: 75 mm
- ▶ Including fixing materials
- ▶ Finishes: SS Satin

| Description | Unit | Article No. | PU |
|---------------------|------|-------------|----|
| HWS 75: Wall magnet | Set | 9 228 402 | 01 |

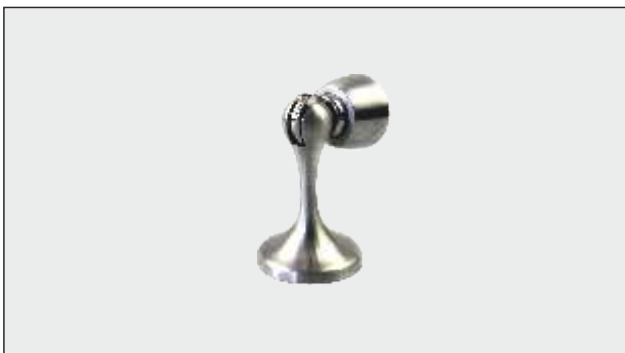

HWS 45: Magnetic Wall Stop (Floor Mounted)

- ▶ Material: stainless steel
- ▶ Finishes: SS Satin Including fixing materials

| Description | Unit | Article No. | PU |
|--|------|-------------|----|
| HWS 45: Magnetic Wall Stop (Floor Mounted) | Pc | 9 228 707 | 01 |



HPP 1: Pull plate for door

- ▶ Size: 300 mm x 100 mm
- ▶ Including fixing materials
- ▶ Finishes: SS Satin

| Description | Unit | Article No. | PU |
|-------------------|------|-------------|----|
| HPP 1: Pull plate | Pc | 9 228 403 | 01 |



HPP 2: Push plate for door

- ▶ Size: 300 mm x 100 mm
- ▶ Including fixing materials
- ▶ Finishes: SS Satin

| Description | Unit | Article No. | PU |
|-------------------|------|-------------|----|
| HPP 2: Push plate | Pc | 9 228 404 | 01 |



HDC 1: Security door chain

- ▶ Suitable for wooden inward opening doors
- ▶ Fixing material included
- ▶ Finishes: Chrome plate

| Description | Unit | Article No. | PU |
|----------------------------|------|-------------|----|
| HDC 1: Security door chain | Set | 9 228 405 | 01 |

Door Accessories



- HDC 2: Door Guard**
 ▶ Material: stainless steel
 ▶ Finishes: SS Satin Including fixing materials

| Description | Unit | Article No. | PU |
|-------------------|------|-------------|----|
| HDC 2: Door Guard | Pc | 9228708 | 01 |

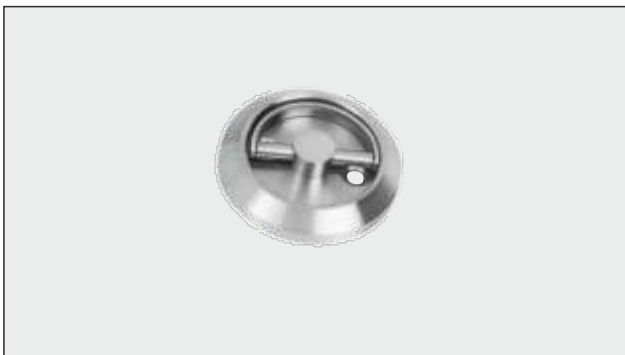

- HFP 1: Flush Pull-on Rose for Door**
 ▶ Size: 12 mm x 76 mm
 ▶ Center - center: 38 mm
 ▶ Fixing material included
 ▶ Finishes: SS Satin

| Description | Unit | Article No. | PU |
|------------------|------|-------------|----|
| HFP 1: Pull ring | Pc | 9 228 406 | 01 |



- HDS 44: Half-Dome shape floor mounted door stopper**
 ▶ Material: stainless steel
 ▶ Finishes: SS Satin Including fixing materials

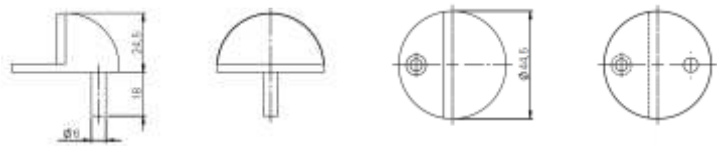

| Description | Unit | Article No. | PU |
|--------------------------------------|------|-------------|----|
| HDS 44: Door stopper - floor mounted | Pc | 9 228 407 | 01 |



- HDS 45: Vertical type floor mounted door stopper**
 ▶ Material: stainless steel
 ▶ Finishes: SS Satin Including fixing materials

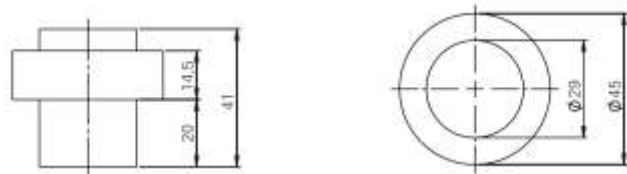

| Description | Unit | Article No. | PU |
|--------------------------------------|------|-------------|----|
| HDS 45: Door stopper - floor mounted | Pc | 9 228 408 | 01 |



- HDS 46: Hanging type Door drop stop**
 ▶ Material: stainless steel
 ▶ Finishes: SS Satin Including fixing materials

| Description | Unit | Article No. | PU |
|-------------------------------------|------|-------------|----|
| HDS 46: Hanging type Door drop stop | Pc | 9 228 709 | 01 |

Door Accessories



HDS 47: Vertical type Door drop stop
 ▶ Material: stainless steel
 ▶ Finishes: SS Satin Including fixing materials

| Description | Unit | Article No. | PU |
|--------------------------------------|------|-------------|----|
| HDS 47: Vertical type Door drop stop | Pc | 9 228 710 | 01 |



HWS 76: Door stopper – wall mounted
 ▶ Material: stainless steel
 ▶ Finishes: SS Satin Including fixing materials

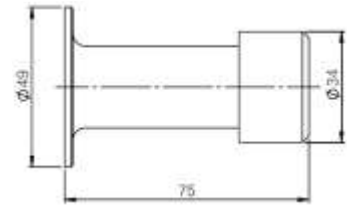

| Description | Unit | Article No. | PU |
|-------------------------------------|------|-------------|----|
| HWS 76: Door stopper – wall mounted | Pc | 9 228 409 | 01 |



HDV 1: Door Viewer
 ▶ Lens diameter: 37 mm, Lens cone diameter: 22 mm
 ▶ Suitable for door thickness: 35 - 55 mm
 ▶ 180° view, nylon with cover plate from indoor side
 ▶ Finishes: Chrome plating

| Description | Unit | Article No. | PU |
|--------------------|------|-------------|----|
| HDV 1: Door Viewer | Pc | 9 228 410 | 01 |



HDV 2: Door viewer
 ▶ Lens diameter: 25.4 mm, Lens cone diameter: 14 mm
 ▶ Suitable for door thickness: 35 - 55 mm
 ▶ 140° view, nylon with cover plate from indoor side
 ▶ Finishes: Chrome plating

| Description | Unit | Article No. | PU |
|--------------------|------|-------------|----|
| HDV 2: Door viewer | Pc | 9 228 439 | 01 |

Registered & Head Office:**Hettich India Private Limited**

302, Duro-lite House,
Opp. SAB TV, New Link Road,
Andheri (West), Mumbai - 400 053
Phone: +91 22 2674 3289/3356/4089
Fax: +91 22 2674 3267

Delhi Office:**Hettich India Private Limited**

A-26/4, 1st floor,
Mohan Co-operative Industrial Estate,
New Delhi - 110 044
Phone: +91 11 4889 4000, 4889 4005
Fax: +91 11 4889 4044

Vadodara Factory:

Plot No. 304, Dhanora,
Nandesari Road,
Near ECPL,
Village - Dhanora - 391 346
Dist. - Vadodara
Tel: + 91 26 5656 9003

11.2007

Application Centres:**New Delhi:**

61, Panchkuian Road,
New Delhi - 110 001
Ph. No. : +91 11 2358 0713,
2358 4603

Mumbai:

202, Duro-lite House, Opp. SAB TV,
New Link Road, Andheri (West),
Mumbai - 400 053
Ph.No. : +91 22 2639 9707

Chennai:

"Heavitree", Ground Floor,
47, Spur Tank Road,
Chetpet, Chennai - 600 031
Ph. No. : +91 44 4263 7227

Kolkata:

2nd Floor, Unit Number 2A,
Tirumala 22, East Topsia Road,
Police Station Tiljala,
Kolkata - 700 046
Ph. No. : +91 98310 12054

Hyderabad:

" Sai Krishna "
797 - A, Road No. 36,
Jubilee Hills,
Hyderabad - 500 034
Ph. No. : +91 40 2355 8994

Pune:

Ishanya Speciality Mall,
C G 00-01, 2nd floor,
Arcade-2, Opp.Golf Course,
Yerwada, Pune - 411 006,
Ph. No. : +91 20 4132 2638

Bangalore:

Adventz Center, Ground Floor 28,
Cubbon Road, Shivaji Nagar,
Bangalore - 560 001
Ph. No. : +91 80 4530 0400,
4530 0401

Lucknow:

Umrao Plaza, 2nd Floor
B - 3, Indira Nagar,
Faizabad Road,
Lucknow - 226 016
Ph. No. : +91 52 2407 8889

Ahmedabad:

1st Floor, Unit No. 102,
Safal Pegasus,
Anand Nagar,
Ahmedabad - 380 015,
Ph. No. : +91 79 4032 2824

Chandigarh:

2nd Floor, Aspire Tower,
Plot no. 55, Industrial
& Business park, Phase 1,
Chandigarh - 160 002
Ph. No. : +91 172 5012347

Indore:

Office No.106 and 107-A,
"Brilliant Titanium",
Plot No.9, Scheme No.78, Part-II,
Indore - 452 010, Madhya Pradesh,
Ph. No. : +91 96 9168 4480

Kochi:

41/2062D, 2nd Floor
Palarivattom signal
junction, NH 47 By-pass,
Kochi - 682 028
Ph. No. : +91 048 4402 8242

Enquiry & Customer Services

Toll Free : 1800 209 2096 (office hours)

Email: sales_enquiry@in.hettich.com

customer_services@in.hettich.com

www.hettich.com

