

- +  Alliance
- +  Applications
- +  Technology
- +  Security
- +  Convenience
- +  Products

# Program overview

## Individual plug-connected systems

Every controller has two plug connections to the locking mechanisms. These plug connections can be used alternately. Depending on the requirements of the furniture unit, the locking mechanisms are either plugged directly into the controller or connected to the controller indirectly via a lead.

Connecting leads, mechanisms: see page 17.

### Identification

The transponders are assigned to individual people and communicate with the controllers at the push of a button within a maximum radio range of 0,4 m.

Transponders: see page 16.

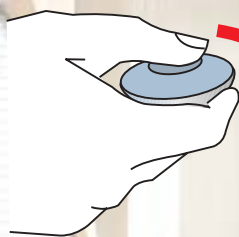

### Unlock if authorised

If the transponder is duly authorised, the controller will unlock the door – also only within freely definable periods of time during the day or week if desired.

Controllers: see page 17.

### Strategic locking

The locking strategy can be freely selected:

- Automatically after 5 seconds
- Automatically at a programmed time of day
- In response to the transponder button

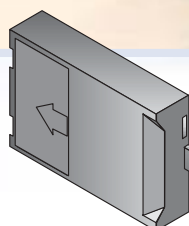
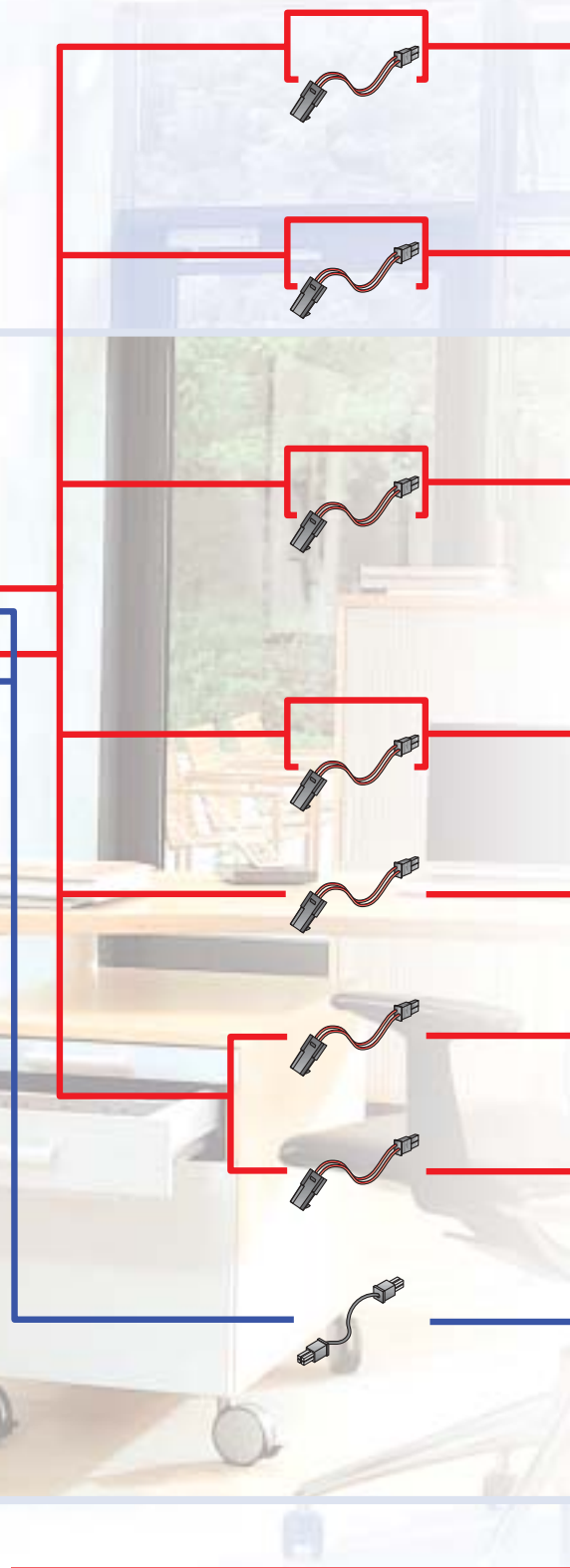
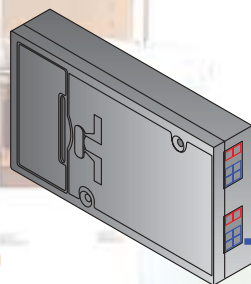

All components are

- installed inside the furniture,
- invisible from the outside and
- protected against manipulation (passive safety).

This ensures total freedom of design for the fronts and a free choice of handles.

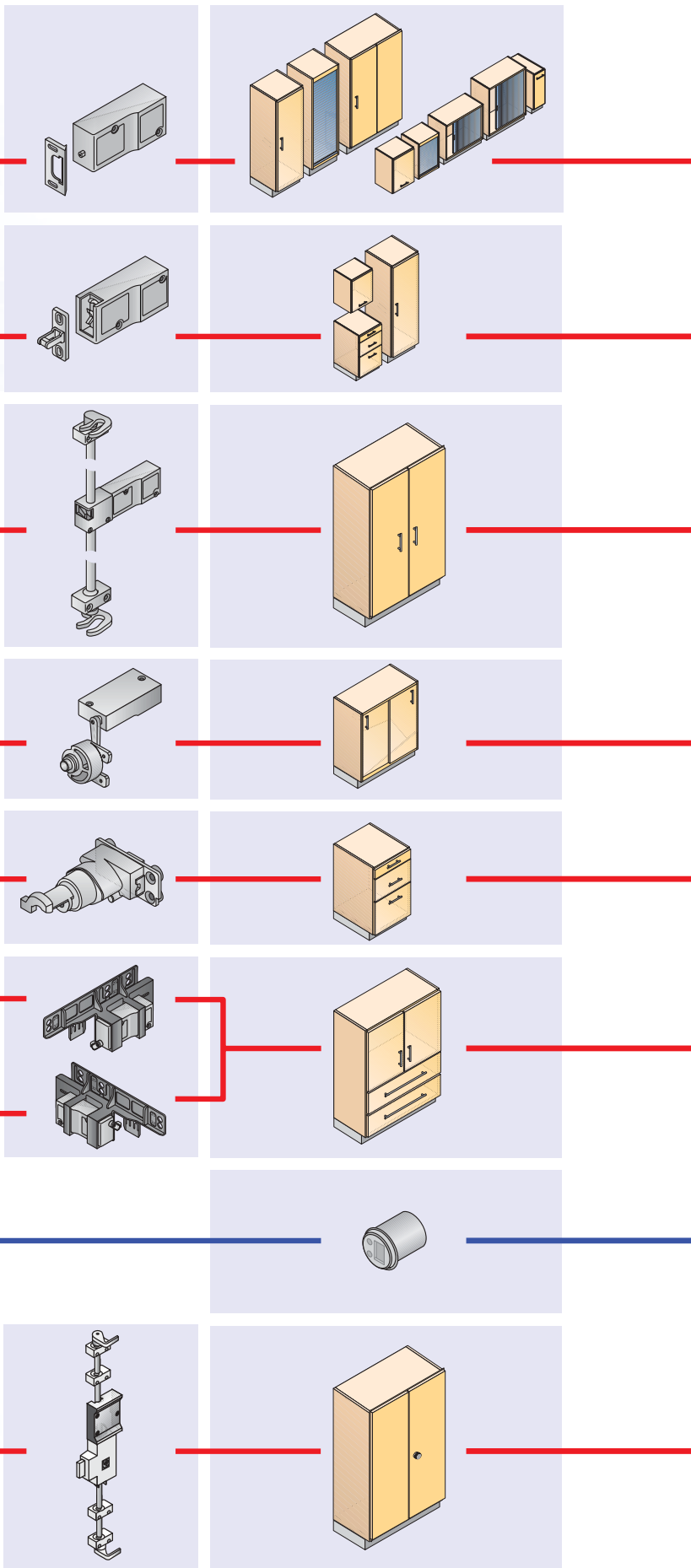

#### Pin locking mechanism set

for locking

- single hinged doors
- flaps
- vertical tambour cabinet
- horizontal tambour cabinet
- folding/sliding doors
- Org@Tower and others

See pages 18 – 19

#### Latch locking mechanism set

for locking

- single hinged doors
- flaps
- drawers and others

See pages 20 – 21

#### Two-point locking mechanism set

for locking

- single hinged doors
- double hinged doors

See pages 22 – 23

#### Sliding door locking mechanism set

for locking

- sliding doors

See pages 24 – 25

#### Workstation pedestal locking mechanism set

for locking

- workstation pedestals with STOP-CONTROL PLUS locking system

See pages 26 – 27

#### Cupboard locking mechanism set

for locking

- cupboards with two-sided STOP-CONTROL PLUS locking system

See pages 30 – 31

#### Optical feedback unit

as optional additional signal for the locking or unlocking operation

See page 32

#### E01 controller with rod immobiliser

for locking

- espagnolette locks with handle option

See pages 34 – 35